

NICROX

User Manual



*Picture is for illustration purposes only

CONTENTS

- SAFETY INSTRUCTIONS..... 3
- PRODUCT DIAGRAM 4
- DISPLAY OPERATIONS..... 6
- OPENING E-SCOOTER..... 7
- FOLDING E-SCOOTER 8
- BATTERY CHARGING..... 10
 - CHARGING..... 11
- OPERATION..... 11
 - LEFT HANDLEBAR SWITCH11
- TIRE SAFETY..... 12
- DRIVING TECHNIQUE 13
- PRODUCT MAINTENANCE..... 13
- TROUBLESHOOTING 14
- SPECIFICATIONS AND PARAMETERS 14
- ENVIRONMENT PROTECTION 14
- TERMS AND CONDITIONS OF WARRANTY 15

SAFETY INSTRUCTIONS

- Read this manual carefully before first use and keep it for future references.
- Always follow local laws and regulations while driving e-scooter.
- This scooter can use one person at the time.
- It is not recommended to do stunts or jump, it can increase risk of injury.
- You should be extra careful when riding in poor visibility, bad weather conditions or in the evening.
- Before using e-scooter wait until all moving parts such as brakes and hinges are automatically adjusted.
- Your first ride should be in flat area without obstacles.
- Release speed control before braking.
- Wear protection gear included helmet and shoes.
- Be careful when riding the e-scooter in rough or uneven terrain. Do NOT put yourself or others into dangerous situations.
- Regularly check all parts and immediately exchange worn or damaged parts.
- Do NOT use damaged product or when there are sharp objects on the product.
- Incorrect use can lead to serious injury, damaging properties or death.
- Do NOT use on public roads or traffic.
- Keep away from kids and pets. This is not a toy.
- Do NOT drive on steep slopes and always control your speed.
- Don't carry items on this device.
- Do not expose the battery to extreme temperatures and direct sunlight. Keep the battery in dry and cold place.
- Maximum weight limit: 150 kg

PRODUCT DIAGRAM



1.	Grip	6.	Accelerator
2.	Light switch	7.	Key
3.	Turning light switch	8.	Motor shift switch
4.	Horn	9.	Left brake level
5.	Display	10.	Right brake level



11.	Stem	21.	Rear fender
12.	T-bar	22.	Rear fender cover
13.	Quick-release	23.	Front tire
14.	Steering rod/handletube	24.	Rear suspension
15.	Front suspension	25.	Rear fork
16.	Front light	26.	Bolts
17.	Headset	27.	Kick stand
18.	Light cover	28.	Charging mouth
19.	Front suspension cover	29.	Brake
20.	Folding handle bar	30.	Brake disc

DISPLAY OPERATIONS

1. APPERANCE

DISPLAY OPERATION MANUAL



1 Current speed

4 Power button

7 Trip time

2 Speed level

5 Accelerator

8 USB port (on the back of the display)

3 Mode button

6 Battery capacity indicator

Displayed values when turned ON

a/current speed inkm/h

b/speed level: 1-slow; 2-middle; 3-fast(last set)

c/battery capacity (the indicator varies depending on the current load / power consumption of the engine)

d/trip time

e/ PAS: non zero start activated(when the e-scooter stands, the accelerator does not respond)

Speed level set

The e-scooter features three speed modes that adjust the speed level. When the display is turned on, the last used speed level is set.

Change the speed level:

press the Power button shortly-the speed level number starts blinking on the display

press the Mode button shortly to change the speed level

to save the desired level, press the Power button shortly or leave the display idle

Display functions

Press the Mode button shortly and the functions rotate as follows:

TRIP-single ride distance. Press Mode button long to reset it to zero.

ODO-total distance traveled in km

CHA-no function

VOL-current voltage(it may fluctuate during the ride/load)

DST-no function

CHTIME-when switched to this function, the display turns off in 2 hours (time countdown); You may appreciate it while charging a mobile phone from a USB port

TIME-trip time

When the display is idle for 3 minutes it will automatically turn off(if countdown CH TIME is not activated).

OPENING E-SCOOTER

Step 1



NOTE:

- To pull back the red handle bar to the end. Then push the black handle tube/ the steering rod to vertical position. Release the red handle bar.

Step 2

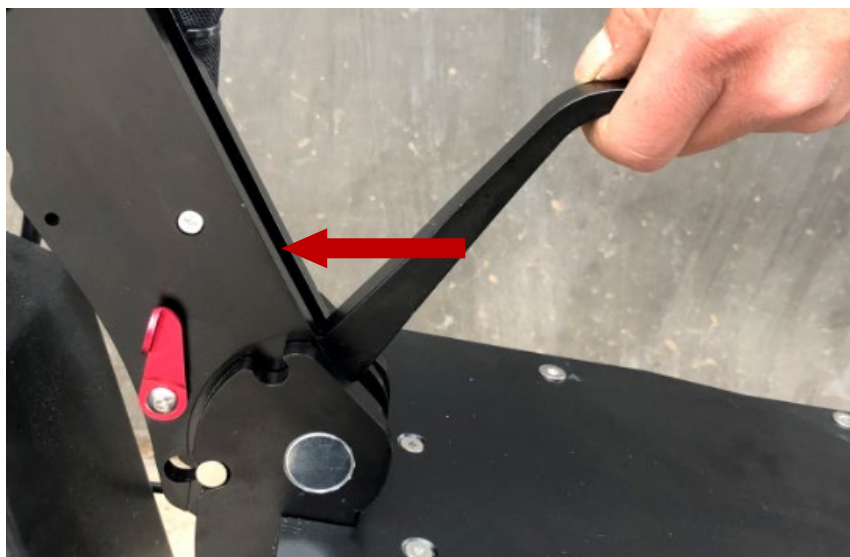

NOTE:

- To push the red handle bar to the end. In order to lock the handle tube not to fall down.

FOLDING E-SCOOTER

Step 1

NOTE:

Push the black handle bar to the deck.



Step 2

Pull back the red handle bar to the end. Then fold the steering rod towards the rear wheel.

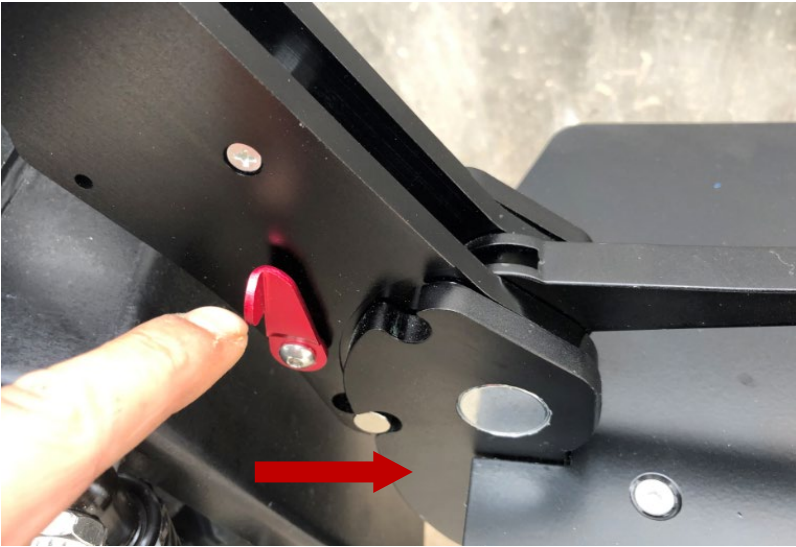

BATTERY CHARGING

BATTERY

- Never operate the battery during charging.
- Indicator lights in the throttle are intended only for general knowledge. (full/empty) and doesn't give a precise indication of the battery status.
- Don't store the scooter for a long time (over 2 months) with fully charged battery.
- Discharge the battery from time to time by riding the scooter in the red led light position until it slows down and stops.
- Don't use the battery, if it is broken, if emits unusual odor, is overheated or there is some leakage from it.
- Avoid contact with any substance coming from the battery.
- Keep it away from children and pets.
- Improper manipulation or exposing to incorrect voltage can result in injury or death.
- Improper using, storing or charging could void the warranty or break the battery.

CHARGING

- Your E-scooter has an external charger. Connect the charging cable to the scooter charging socket under the footboard on the right side at the rear. Then connect the charger electric cable to an electrical outlet.



Charger lights red – battery is charged

Charger lights green – charging has been completed

- Avoid long periods with an uncharged or fully charged battery.
- To maximize your e-scooter battery performance, charge it fully for 9 hours a month.
- Unplug device from the outlet before installing or removing the battery or before maintenance. It is dangerous to operate the scooter when it is plugged into an AC outlet. This could result in an electric shock, injury or product damage.
- Don't try to open the battery. Never insert any item into the battery to avoid an injury or fire. There are toxic and dangerous substances inside it that could endanger your health or environment.
- Use only original charger and only original battery. The battery and product should be disposed according to local laws and national requirements.

WARNING: Do not expose the battery to extreme temperatures and direct sunlight. Keep the battery in dry and cold place.

OPERATION

- There is ON/OFF  button on the throttle. Press this button to operate the scooter. The indicator lights turn on.
- Push the button  once long to turn off the scooter.





WARNING: Release speed control before braking.

Left handlebar switches

- Push button of speed control to accelerate the device.



	
1) High speed/Low speed choice	
2) Single motor /dual motor choice	

TIRE SAFETY

WARNING: Follow local laws and requirements for using this device in place where there you intend to ride. Never violate local laws and restrictions.

To protect your head from an injury (that happens frequently) use an approved helmet and protectors. Never use damaged or worn protective garments. Always use a helmet and wear it correctly.

Safety test: Before each ride make a visual inspection. Check that all bolts and nuts are well tightened. Regularly check it for damage or wearing. Never use damaged or worn product and replace broken parts immediately. Contact authorized service.

Check the wheels and tires regularly as well. Rotate them with fingers to check that they work properly. Check normal rotation of wheels during braking. If it doesn't work properly, contact an authorized service. Check the brake before each riding.

NOTE: To speed up, lean forwards. To brake, shift your weight backwards.

DRIVING TECHNIQUE

- Know the scooter before first use and test your ability to control this product.
- Turn continuously and brake safely having enough free space.
- Practice your first ride in an open area without obstacles.
- Never let distract your mind during riding.

Foot position – put your foot on the board as close to the front part as possible. Let your other foot on the ground. Make sure the route is clean and free. To start riding, push yourself forwards (like on a non-motorized scooter). Push off with the foot that is on the ground. Immediately after pressing the throttle downwards, tilt your body forwards as a prevention from falling back while increasing your speed. Avoid excessive body pressing on the handlebars during speed changing. One foot is at front and the second one is back. It is comfortable to place the feet like on a skateboard for optimal stability.

NOTE: Riding on a scooter can be dangerous. You use the product on your own responsibility and be familiar with all the safety precautions before riding.



Turning – it is the same as on a surf or snowboard. The handlebar should be parallel to the body. Before turning look at the approaching direction to be sure the operation is safe.

Braking – shift your weight backwards so that the braking is realized through your feet and not through handlebar and steering system. Learn well to adjust the gravity center during stopping to avoid turning over or excessive wearing of the braking and steering system.

PRODUCT MAINTENANCE

This product has been designed and assembled by professionals. Don't do any improper modification of the e-scooter or of any part to avoid warranty void or product damage.

Required tools:

	
<p>General utility tool</p>	<p>15-18 Hex</p>

Lubrication – Apply a little amount of lubricating oil or lubricant in the clutch sleeve folding handle every six months.

NOTE: Don't use WD40 (anti-rust oil) to lubricate it. Don't lubricate the front and rear part. If you are not sure, ask an expert.

Tire – if the brake performance gets worse, use a line brake regulator to adjust it to achieve the best braking effect. If the braking or brake sensitivity is still bad or you can hear an unusual noise from the braking system, replace the brake pads and contact a service.

This product is equipped with lithium battery that can recharged for 800 times. If the battery gets empty in a short time, it should be replaced.

TROUBLESHOOTING

If the product doesn't work normally, check it following the points below:

- Check if the power switch is on or not
- Check the battery power
- Check brake
- Check that all sockets and connectors are clean and right

If everything seems to be right and the scooter still doesn't work, contact the service.

SPECIFICATIONS AND PARAMETERS

Motor Specification	Rated output power	2400 W
	Rated voltage	60 V
	Battery capacity	26 AH
	Range	70-80 kms
Product specification	Dimensions	120x65x115cm
	Front and rear center distance	850 mm
Performance	Weight	43 kg (with battery)
	Max. load	150 kg
	Max. speed	60 km/h
	Climbing angle	30°
	Battery type	Ternary lithium electricity
Motor	Motor	DC brushless motor
Charger	Input voltage	AC 100-240 V
	Output current	3 A
	Charging time	5-8 h
Tires	Tire size	11"
	Tire type	Off road
Brake	Brake type	Front and rear disc brake
Light	LED	Front light with horn

ENVIRONMENT PROTECTION

After the product lifespan expired or if the possible repairing is uneconomic, dispose it according to the local laws and environmentally friendly in the nearest scrapyards.

By proper disposal you will protect the environment and natural sources. Moreover, you can help protect human health. If you are not sure in correct disposing, ask local authorities to avoid law violation or sanctions.

Don't put the batteries among house waste but hand them in to the recycling place.

TERMS AND CONDITIONS OF WARRANTY

General Conditions of Warranty and Definition of Terms

If product has the following problems within warranty period, the product distributor will provide a complete after-sales service within the scope of the quality guarantee.

Spare Parts	Problem	Warranty Period	Not including
Motor	Malfunction in normal use	1 year	misuse
Controller	Malfunction in normal use	3 months	
Battery	Cannot charge	1 year	Battery with water, battery dead after long time no charge
Frame Body	Distorted or broken in normal use	1 year	Misuse

Attention: to ensure your safety during use, do not disassemble or modify product.

This will cause some unpredictable security risks. Products that are disassembled or modified without permission will not be able to enjoy free warranty service.

Within the warranty period, failure or damage caused by the following causes is not within the scope of quality assurance:

1. Not properly maintained in accordance with this instruction manual.
2. Damage or malfunction caused by using product as dangerous purposes such as performance.
3. Disassemble without permission or use other brand spare parts.
4. Undefined use, traffic accident or other impacts.
5. Driving on an abnormal road causes to damage or malfunction.
6. Commercial rental use or improper use of non-privilege.
7. Irresistible Disaster.

The supplier will send the spare parts in warranty to buyer and the supplier will pay shipping cost by air to door for the spare parts in warranty.



Nordbutiker i Sverige AB

Gösvägen 28

76141 Norrtälje

08-522 309 80

info@nordbutiker.se